

STORM DRY[®]

EP-BOARD

Application

GUIDELINES



- High performance low profile insulation
- Improves EPC rating points
- Fast installation



Preparation



Before any works are carried out, ensure that the substrate is clean, level and suitable for application of the boards. Carry out repairs or make modifications as necessary. Remove any obstacles or fixings that might hinder application such as radiators, switches or sockets.

Application



Lay the **Stormdry® EP-Board** on the ground with the dark-grey aerogel blanket facing up. Apply **Stormdry® EP-Board Adhesive** in a continuous line inset approximately 30 mm from the edge of the board until the entire perimeter has been covered. Infill the remainder of the board with the adhesive in a single, wide zig-zag pattern.



Pick up the **Stormdry® EP-Board**, making sure to grip it at the edges, and offer the adhesive covered side up to the wall. Apply gentle pressure and hold the board in place until the adhesive provides enough adhesion to support itself, making sure that the board is level with the wall. Repeat the process with more boards, tiling them across the wall until the wall is completely covered. They can either be staggered or applied inline.

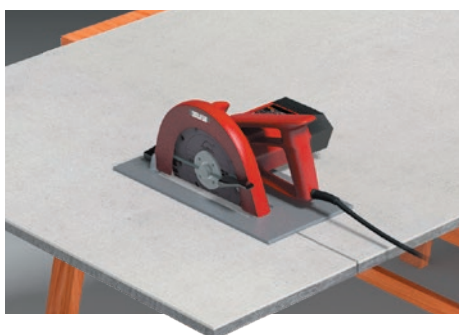

Cutting Boards

In order to completely cover a wall, it will most likely be necessary to cut some **Stormdry® EP-Board** down to size. Cutting should be carried out outside or in a well-ventilated area with an appropriate dust sheet. Always wear the correct PPE equipment including gloves, goggles and a dust mask. Cutting should be done using either a jigsaw or a mechanical saw. Cuts should always be made from the light grey Magnesium Oxide face of the board.



Where sockets and fixing need to be cut out, take measurements, mark up the board, drill a hole at each corner and cut out to the correct shape using a jigsaw.

Application Cont.

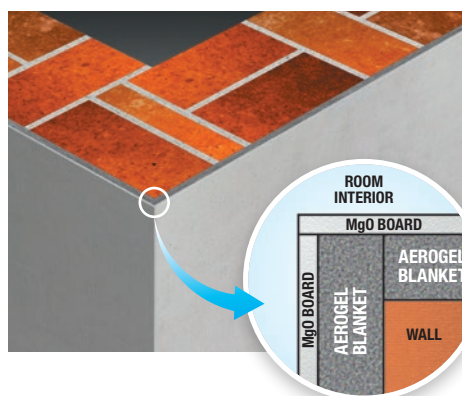

Internal and External Angle Corner Joints

At corners, it is important that the aerogel insulation is allowed to overlap. This prevents a cold bridge at the join between the two boards.

External Angle Corner Joints

For external angle corner joints, one of the boards will need to extend past the edge of the corner by 10 mm. The second board will require the aerogel blanket on the joining side to be cut back 13 mm inset from the edge of the magnesium oxide board. This will allow for the second board to overlap the edge of the first board.

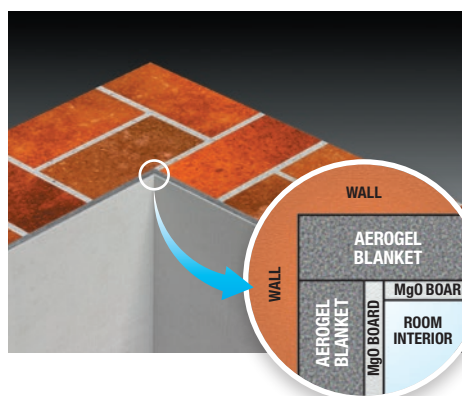

Internal Angle Corner Joints

For internal angle corner joints, one of the boards will require the magnesium oxide board to be cut back 13 mm inset from the edge of the aerogel blanket. To cut whilst retaining the aerogel, cut between board and aerogel to the depth required, e.g. 13 mm, prior to cutting board. The second board will be able to slot in to the gap.



Jointing Panels

Joints between the panels can be filled out using a standard skim tape, jointing compound and sanding techniques. Corner beads should be employed to joint corners.

Decoration

Make sure that the boards are clean and free of dust or debris before applying an even coat of **Stormdry® EP-Board Primer** across the entire boarded wall surface. Once this is dry, the wall will be able to accept standard interior finishes such as paints, plasters and wallpapers.

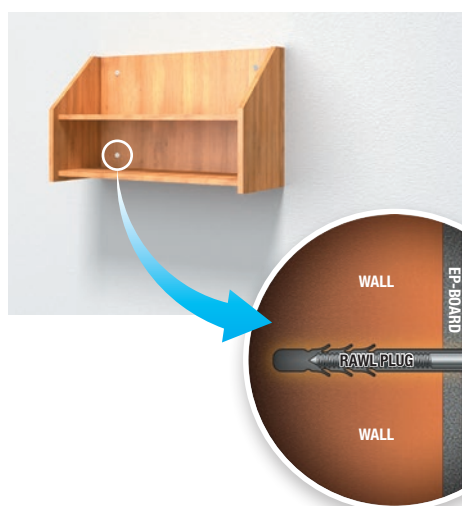

Subsequent Fixings

For the reinstatement of fixings or the installation of new fixings, such as shelving or appliances, it is important that they are installed through the **Stormdry® EP-Boards** and fixed directly to the substrate behind them. The **Stormdry® EP-Boards** should not be bearing the load of any fixings.

STORM DRY[®]

EP - BOARD

Designed to be used with

STORM DRY[®]
MASONRY PROTECTION CREAM



Safeguard Europe Ltd

Redkiln Close,
Horsham, West Sussex,
United Kingdom. RH13 5QL

Telephone: 01403 210204 Fax: 01403 217529

Email: info@safeguardeurope.com

www.safeguardeurope.com

www.stormdry.com