

DRYBASE[®]

LIQUID-APPLIED DPM

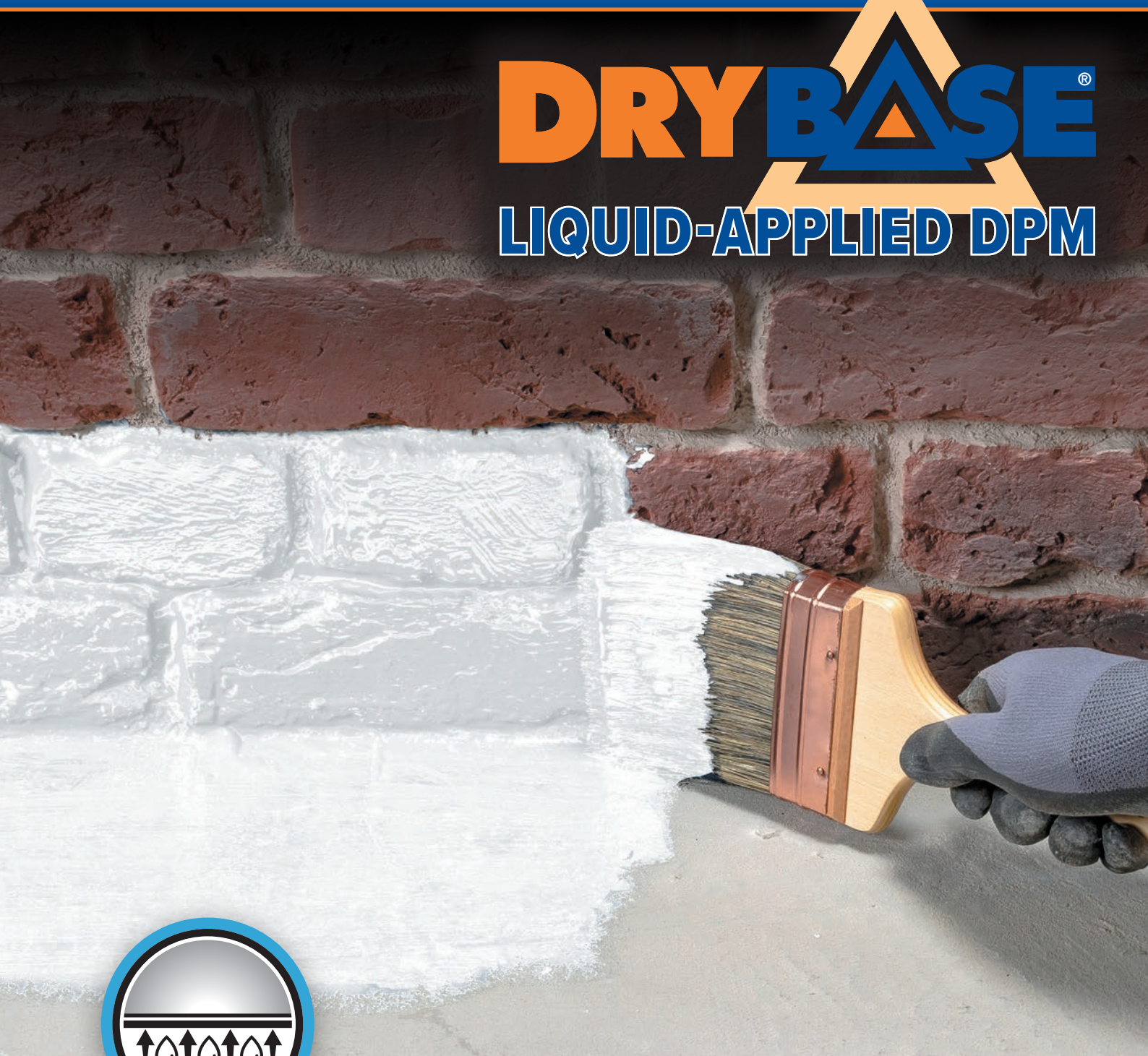

**DAMP AND
VAPOUR
BARRIER**

Application

G U I D E L I N E S

Preparation

Drybase® Liquid DPM should only be applied to a clean and sound substrate. Remove all surface laitance, dust, loose particles, paint, etc. by means of wire brushing, sanding or other suitable mechanical abrasion. Do not apply to a dusty surface. All dust should be vacuumed. To assist the membrane in fully 'wetting out', the substrate may be dampened. There should be no standing water. Newly laid cementitious screeds and self-levelling compounds should be allowed to fully cure before applying **Drybase® Liquid DPM**. Only apply **Drybase® Liquid DPM** in conditions above 7 °C. No special curing is required. Ensure adequate ventilation.

Sound surfaces: for sound surfaces no priming is necessary. To assist the membrane in fully wetting the background can be dampened with clean water. There should not be any standing water.

Weak, friable surfaces: for surfaces with laitance and loose material there are two options to prime the surface before application:

Option 1 – remove the weak top surface by scabbling the floor and sweeping/vacuuming up all dust and loose material. Apply two coats of **Drybase® Liquid DPM** as normal.

Option 2 – remove all dust, previous coatings and loose material by sweeping/vacuuming. For the best adhesion apply a coat of neat Drybase® Bondaid Plus (SBR) to the surface as a primer and wait 20 minutes, or until tacky before applying 2 coats of **Drybase® Liquid DPM**. Alternatively, dilute the first coat of **Drybase® Liquid DPM** with 30% water for use as a primer. Maximum bond can be achieved by vigorously brushing the primer coat into the floor substrate using a stiff bristled broom. Once dry apply two coats of **Drybase® Liquid DPM** as normal.

Test Area

Because of the wide variety of possible substrates and site conditions, it is always advisable to check adhesion to the background by testing on a sample area before starting any job.

Limitations

Drybase® Liquid DPM is not intended as a trafficable surface and should not be used where it will be externally exposed to direct sunlight. Not suitable for use in situations under negative water pressure such as basements and other below ground situations – Drybase® Tanking Slurry is recommended in these situations. Do not directly bond wooden flooring to **Drybase® Liquid DPM** coated concrete.

Coverage

Pack size	As a Vapour Barrier ^[1]	General Purpose ^[2]
1 litre	0.9 m ²	1.4 – 1.8 m ²
5 litres	4.5 m ²	7 – 9 m ²

^[1] A minimum dry film thickness of 0.6 mm (1.1 mm wet film) is required. This should be applied in at least two coats with each at 0.55 litres/m².

^[2] The coverage rate will vary depending upon the roughness and absorbency of the surface, use as a guide only.

Application



1

Before application, sweep the area to remove any loose material, then vacuum thoroughly. Dampening the area will help 'wetting out', but do not leave any standing water. Unsound surfaces will need to be primed before application.



2

Open the tub, stir well and pour into a painter's tray. Excessively damp, humid or cold conditions should be avoided before application.



3

Drybase® Liquid DPM is applied in two coats by brush or roller. Apply the first coat, moving in one plane, back and forth. Allow the first coat to become touch dry – usually 1 hour.



4

Apply the second coat within 24 hours of the first coat. This coat must be at right angles to the first coat to eliminate pin-holing.

Areas of Application

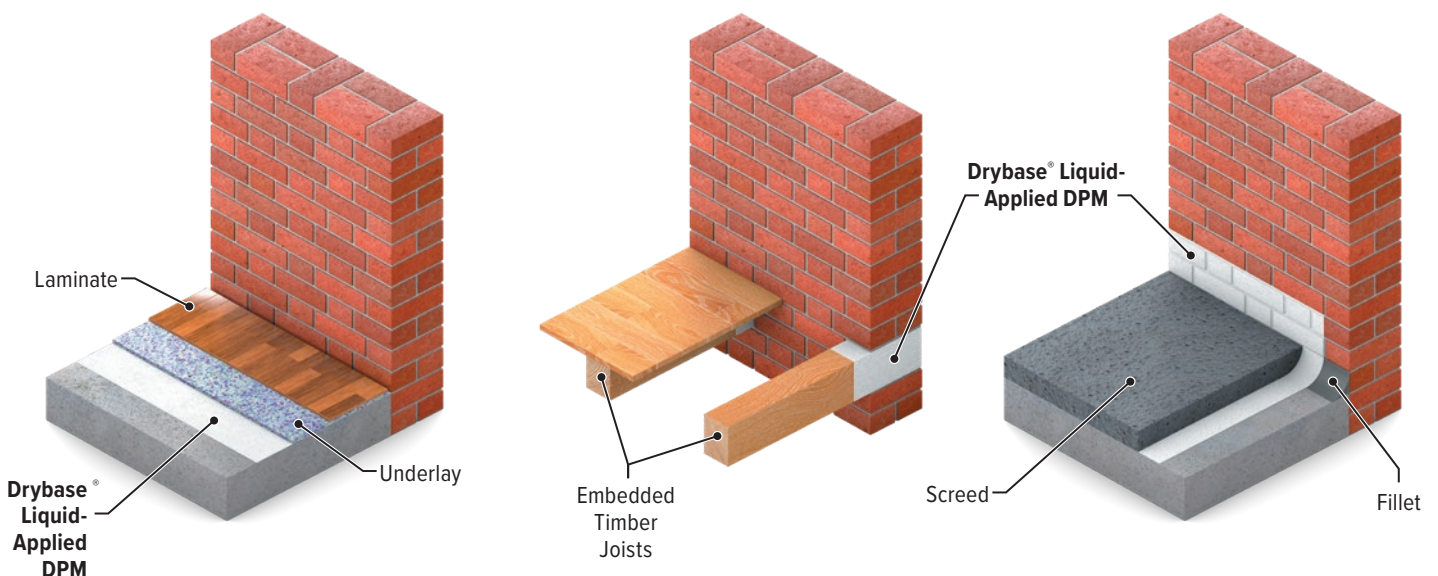



LIQUID-APPLIED DPM

- Damp-proof barriers for floors and walls
- Single component, easy-to-use
- Can act as a barrier to gases and vapours
- Applicable to a wide range of materials
- Water-based and quick drying time
- Available in bitumen-free black or white



Safeguard Europe Ltd

Redkln Close,
Horsham, West Sussex,
United Kingdom. RH13 5QL

T 01403 210204 F 01403 217529

E info@safeguardeurope.com

www.safeguardeurope.com

www.safeguardeurope.com/drybase