

THIS DRAWING IS THE PROPERTY OF SAFEGUARD AND MUST NOT BE LOANED OR COPIED WITHOUT WRITTEN CONSENT

© 2007 SAFEGUARD EUROPE LTD

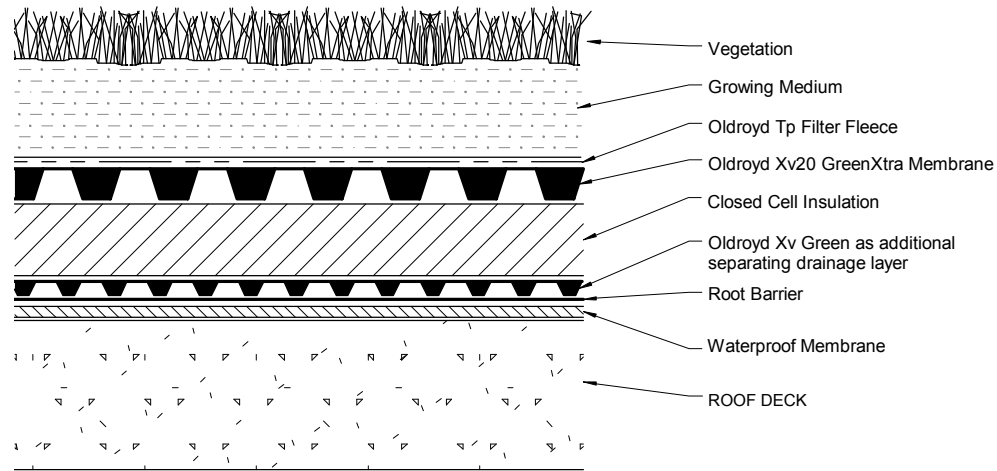

**1. INVERTED ROOF**

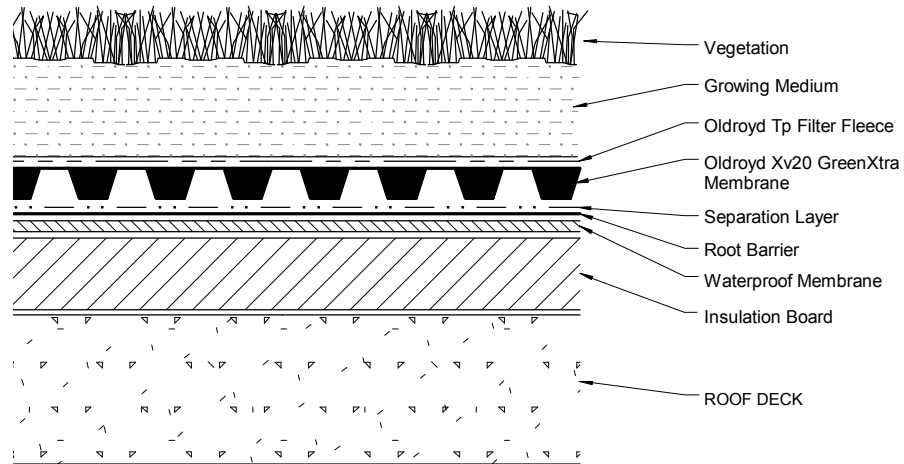

**2. WARM ROOF**

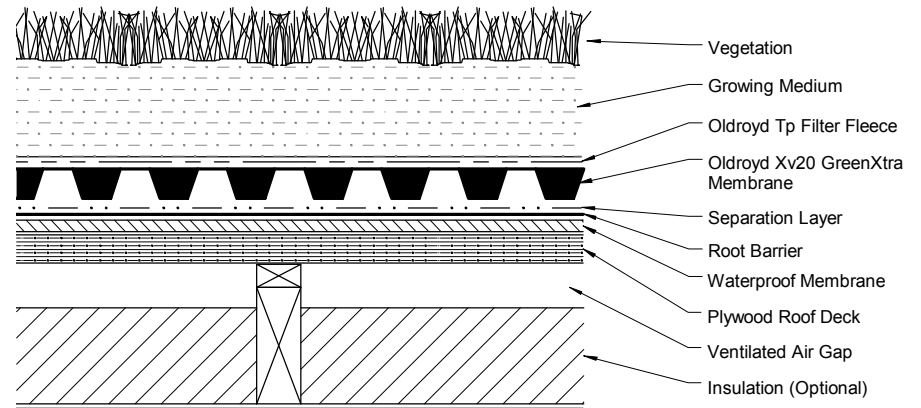

**3. COLD ROOF**

**NOTES:** All SAFEGUARD CAD drawings show typical applications and our Technical Department should be consulted before they are used for specification purposes.  
 Product applicators should refer to the manufacturer's application/installation guidelines.  
 Minimum 1 in 60 falls on roof deck.

System Drg. Nos:	XV20Gx-001(1).tcw (TurboCAD) XV20Gx-001(1).dwg (Autocad) XV20Gx-001(1).pdf (Acrobat)
CONTRACT No:	
DRAWN	JDF, CBS
DATE	25th September 2007
SCALE (A3)	Not To Scale
CHECKED	
APPROVED	

CLIENT:-	Safeguard Roofing Systems
TITLE:	Roof Sections Using Oldroyd Xv20 GreenXtra From NBS Clause Q37

DRG. No.	REV
XV20Gx-001	1

MOD. BY	DATE	CHK. BY	APP. BY	MOD. BY	DATE	CHK. BY	APP. BY	MOD. BY	DATE	CHK. BY	APP. BY