

# REFURBISHMENT SYSTEM PRODUCTS IN OLD BUILDINGS

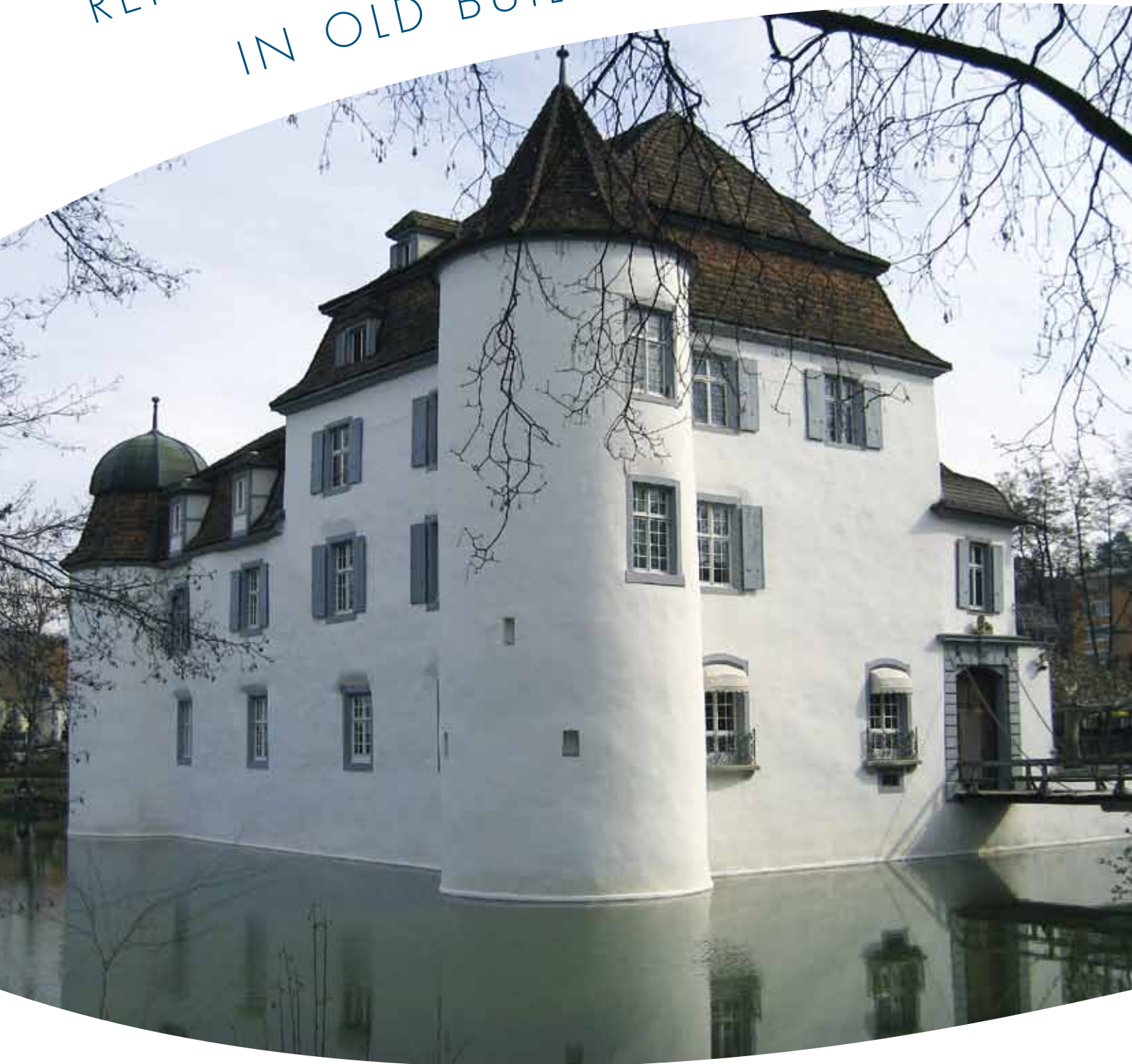

## Valuable properties need not decay!

Old buildings often show efflorescence, damp and plaster damage. Moisture, combined with harmful salts, is one of the main causes of structural dilapidation. Without appropriate counter-measures, buildings decay quickly. So Vandex, keeping abreast with modern technology, have further improved their waterproofing and protection materials, which have been proven over decades, in waterproofing and property refurbishment.

Decay can be stopped by the specific use of Vandex products, and the relevant knowledge.

## Refurbishment of old buildings is worth it!

Damage in old properties means a considerable loss in value. Damp is unpleasant, unhealthy, and destructive. Damp thermal insulation can be ineffective, allowing condensation to form on structural components such as wall ties. Organic components rot and disintegrate. The presence of harmful salts not only causes unsightly efflorescence, but disrupts and destroys masonry, plaster, and decorations.

Investing in refurbishment pays dividends. Property values increase dramatically, and basement space becomes available again for long-term usage. Restoration to a healthy, pleasant room environment returns previously moisture-damaged building areas to a habitable standard. With thermal insulation effective again, considerable savings in heating costs can be realised.

## Vandex property refurbishment system including modern system products

Our competence comes from 30 years experience in property refurbishment. Hence, the Vandex product line conforms both to the latest technical provisions (e.g., CE, BBA\*, WTA\* guidelines) and the presently applicable environmental protection regulations (e.g., mineral products and controlled disposal of containers).

Quality assurance starts with the checking of incoming raw materials and continues through applicator company training.

\*WTA = International Association for the Science and Technology in Maintenance of Structures and Protection of Monuments.

\*BBA = Agrément Certificate  
TECHNICAL APPROVALS FOR CONSTRUCTION

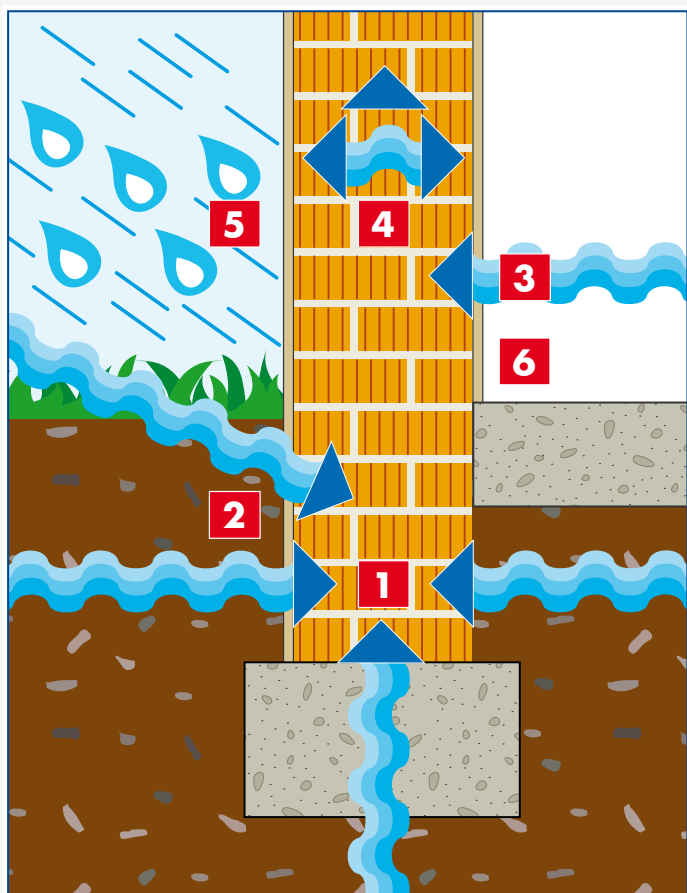

## Vandex refurbishment plaster system - spray applied



### Moisture sources jeopardising property:

- 1 Rising damp
- 2 Lateral penetration
- 3 Hygroscopic moisture
- 4 Condensation
- 5 Exposure to wind-driven rain and splashing water
- 6 Plumbing leaks

## Vandex horizontal DPC mechanism

Horizontal DPC's are installed in existing damp buildings to block or reduce the moisture rising through the capillaries.

## DPC solution with VANDEX IC

VANDEX IC is a water-based ready-to-use silane/siloxane microemulsion cream that provides a barrier against rising damp. The active ingredients in VANDEX IC spread in the capillaries and form an effective hydrophobic barrier against moisture.

The holes with diameter of 12 mm are drilled with a distance of 120 mm on a horizontal level. Depth of the drill hole = wall thickness less 20 mm.

VANDEX IC is applied with a simple applicator gun for 600 ml sausages.



## Vandex 4-module refurbishment system

Using the Vandex 4-module system, virtually any damage can be expertly and comprehensively remedied.

Select the modules relevant to your project.

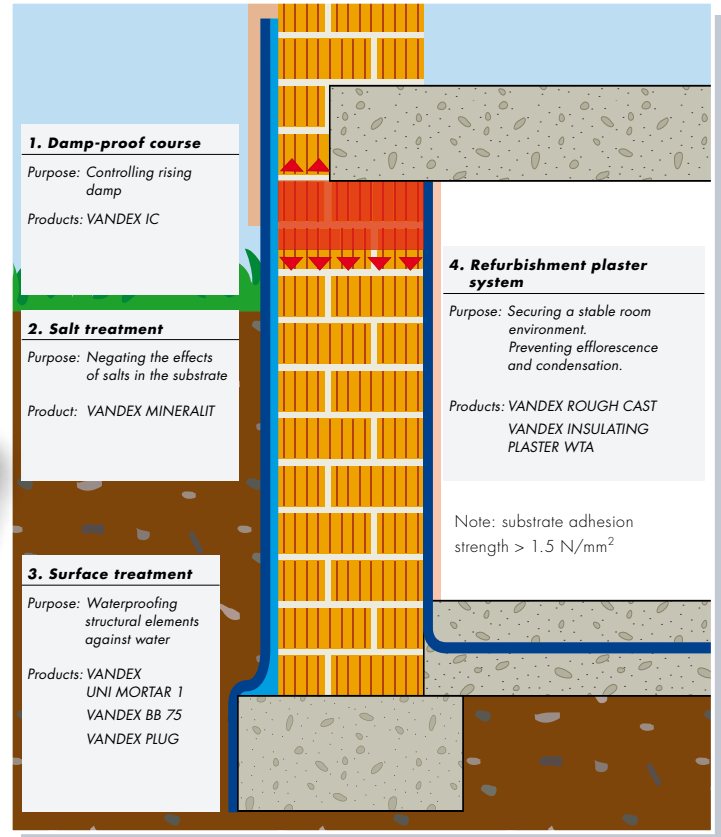

## Moisture limited, no water pressure

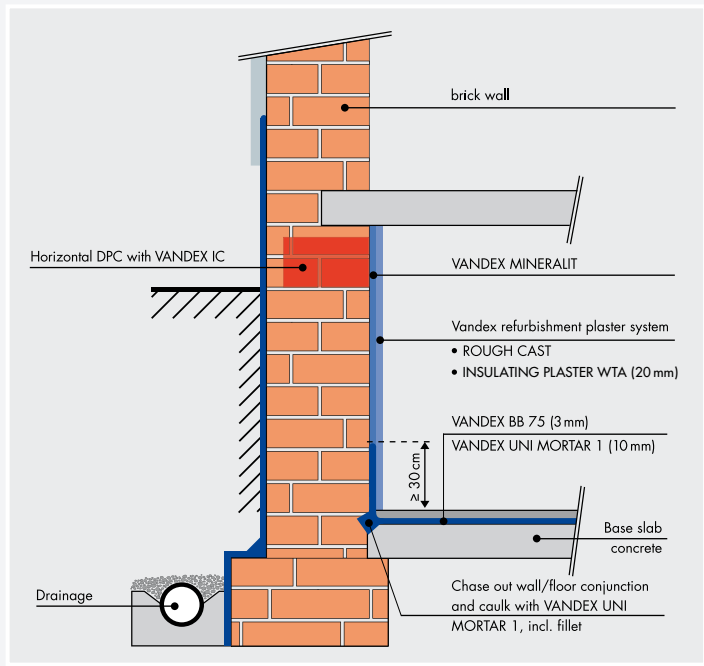

## Internal waterproofing of basement

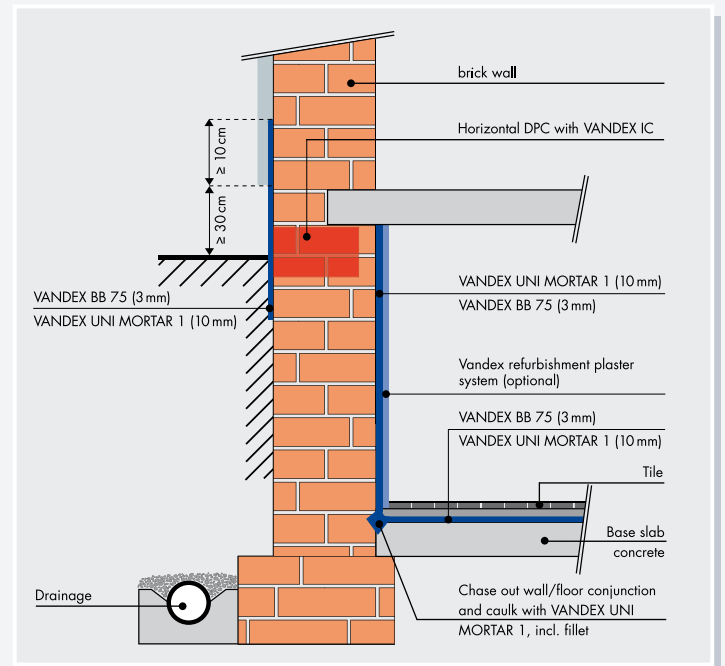

Note: depending on design can VANDEX UNIMORTAR 1 be used as stand alone.



## Typical example of Vandex property refurbishment products



1 Situation before



2 Damaged surfaces



3 Damaged plaster removed



4 First layer; VANDEX UNI MORTAR 1



5 Second layer; refurbishment plaster



6 Finished work

### Selected speciality products and their areas of application

| Product name            | Brief description  | Consumption   | Unit size | Damp-proof course | Salt refurbishment | Brick hardening | Levelling | Bonding | Salt repository | Waterproofing | Fillets | Ingress | Dwelling climate | Decorative finish | Mechanical processing |
|-------------------------|--|---|-----------|-------------------|--------------------|-----------------|-----------|---------|-----------------|---------------|---------|---------|------------------|-------------------|-----------------------|
| IC*#                    | Silane/siloxane damp-proof course, single comp.                | 4 units/10 m in 25 cm wall thickness                                      | 600 ml    | ●                 |                    |                 |           |         |                 |               |         |         |                  |                   |                       |
| UNI MORTAR 1            | Waterproofing and repair mortar, single component              | approx. 16 kg/m <sup>2</sup> (layer thickness approx. 8 mm)               | 25 kg     |                   |                    |                 | ●         |         |                 | ●             | ●       | ●       |                  |                   | ●                     |
| BB 75 # / BB WHITE      | Cementitious waterproofing slurry, single component grey/white | 6 kg/m <sup>2</sup> (layer thickness approx. 3 mm)                        | 25 kg     |                   |                    |                 |           |         |                 | ●             |         | ●       |                  |                   | ●                     |
| ROUGH CAST*             | Ready-mix dry mortar for bonding                               | 5 kg/m <sup>2</sup> (open textured, covering approx. 50 % of the surface) | 30 kg     |                   |                    | ●               |           | ●       |                 |               |         |         |                  |                   | ●                     |
| INSULATING PLASTER WTA* | Ready-mix dry mortar for refurbishment, white                  | 7,5 kg/m <sup>2</sup> (layer thickness approx. 20 mm)                     | 20 kg     |                   | ●                  |                 |           |         |                 |               |         |         | ●                | ●                 | ●                     |
| PLUG                    | Rapid setting mortar to stop water ingress                     | site-dependent  | 15 kg     |                   |                    |                 |           |         |                 | ●             |         | ●       |                  |                   |                       |

VX.B.REF.en.1604

\* Products fulfil WTA specification 2-9-04/D.

# BBA certificate available

- Vandex services:**
- Competent consultation in property refurbishment
  - Problem analysis, proposal of solutions
  - Applicator instructions

The information contained herein is based on our longterm experience and the best of our knowledge. We can, however, make no guarantee since for a successful outcome, all circumstances in an individual case must be taken into consideration. Indications of quantities required are only averages which in certain cases might be greater.



**RPM/Belgium N.V.**

H. Dunantstraat 11B - B-8700 Tielt - T.:+32 (0) 51 40 38 01

**Alteco Technik GmbH**

Raiffeisenstraße 16 - D-27239 Twistringen - T.:+49 (0) 42 43 92 95 0

**Hermeta GmbH**

Kanalstraße 11 - D-12357 Berlin - T.:+49 (0) 30 661 70 72

**Monile France SARL**

10, rue de la Lande - F-35430 St. Jouan des Guerets - T.:+33 (0) 608 86 96 56

**Vandex International Ltd**

Rötistrasse 6 - CH-4501 Solothurn - T.:+41 (0) 32 626 36 36

**Vandex Isoliermittel-GmbH**

Industriestraße 19–23 - D-21493 Schwarzenbek - T.:+49 (0) 41 51 89 15 0

**Vandex AG**

Rötistrasse 6 - CH-4501 Solothurn - T.:+41 (0) 32 626 36 46

**Alteco Polymer Systems**

436 Seventh Avenue, Suite 1850 - Pittsburgh, PA 15219 - T.:+1 216 258 8715